



ASHFORD  
& MOULT  
ESTATE AGENTS

OFFERS IN EXCESS OF

**£210,000**

**Flatts Lane**

Nottingham, NG14 6LA

ASHFORD  
& MOULT  
ESTATE AGENTS



## PROPERTY SUMMARY

Nestled in the charming area of Flatts Lane, Calverton, Nottingham, this well-presented three-bedroom semi-detached house offers a delightful family home. Upon entering, you are greeted by a spacious reception room that provides a warm and inviting atmosphere, perfect for both relaxation and entertaining guests.

The property boasts three comfortable bedrooms, each offering ample space for family living. The family bathroom is conveniently located, complemented by an additional downstairs toilet, ensuring practicality for busy households.

One of the standout features of this home is the lovely conservatory, which extends the living space and allows for an abundance of natural light, creating a serene environment to enjoy throughout the year.

For those with vehicles, the property includes driveway parking for two vehicles, providing convenience and ease of access.

This semi-detached house is an ideal choice for families seeking a comfortable and stylish living space in a friendly neighbourhood. With its thoughtful layout and desirable features, this property is sure to appeal to a wide range of buyers. Don't miss the opportunity to make this lovely house your new home.

Call now to arrange a viewing!!

3



1



1















ASHFORD  
& MOULT  
ESTATE AGENTS

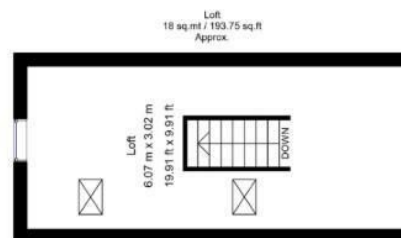
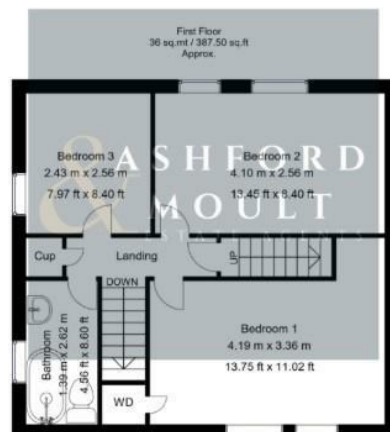
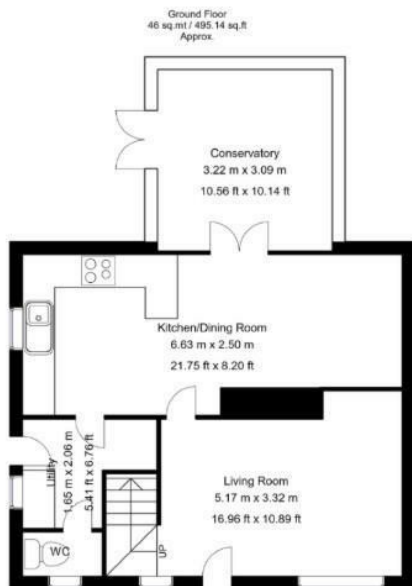

**LOCAL AUTHORITY**  
Gedling Borough Council

**TENURE**  
Freehold

**COUNCIL TAX BAND**  
A

**VIEWINGS**  
By prior appointment only

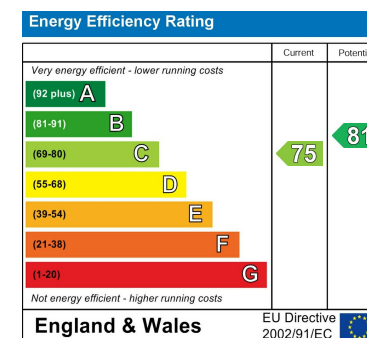

Whilst every attempt has been made to ensure the accuracy of the floor plan contained here, no responsibility is taken for incorrect measurements of doors, windows, appliances and room or any error, omission or misstatement. Exterior and interior walls are drawn to scale based on interior measurements. Any figure given is for initial guidance only and should not be relied on as basis of valuation. These plans are for marketing purposes only and should be used as such by any prospective purchase. Specially no guarantee is should not be relied on as a basis of valuation. These plans are for marketing purposes only and should be used as such by any prospective purchase. Specifically no guarantee is given on the total square footage of the property if quoted on this plan.

CC Ltd ©2018

Agents Note: Whilst every care has been taken to prepare these particulars, they are for guidance purposes only. All measurements are approximate and are for general guidance purposes only and whilst every care has been taken to ensure their accuracy, they should not be relied upon and potential buyers/tenants are advised to recheck the measurements

**ASHFORD  
& MOULT**  
ESTATE AGENTS

**OFFICE ADDRESS**

56 Main Street  
Calverton  
Nottinghamshire  
NG14 6FN

**OFFICE DETAILS**

01158 656675  
sales@ashfordandmoult.co.uk